

Multipurpose Open Shelf Tuffy AV Carts



Holds up to a 20" TV

WT42E

WT34E

WT26E



UL listed carts for 13" & 20" TV's available



UL/CSA approved electrical assembly



The Big Wheel Kit allows your cart to roll over almost any surface.



Ergonomic Handle Textured Surface.

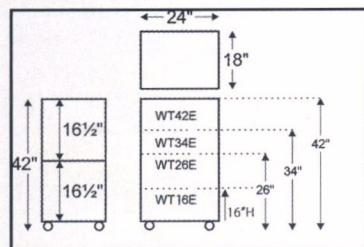

Tuffy Cart Dimensions



14 COLOR CHOICES

Tuffy Open Shelf A/V Carts

- ⇒ Constructed from an engineered thermoplastic resin, injection molded that will not chip, warp, crack, rust or peel. Shelves are 1 1/2" thick and legs are 1 1/2" square.
- ⇒ All Tuffy 18" D x 24" W shelves have a 1/4" safety retaining lip and a raised texture surface to enhance product placement and ensure minimal sliding.
- ⇒ Included with every Tuffy cart is a 3-outlet UL/CSA approved electrical assembly with a 15 ft. cord, cord management wrap and 3 cable management clips.
- ⇒ Electrical attachment is recessed to insure easy passage through doorways and other tight spots.
- ⇒ Four 4" silent roll full swivel ball bearing casters, two with lock max. weight rated at 125 lbs. each.
- ⇒ 3 shelf models will hold 200 lbs. evenly distributed. Top shelf has a grommet hole for cable management.
- ⇒ Available in 16", 26", 34" and 42" Heights.
- ⇒ Our UL Listed Models (WT42BEUL13 for 13" TV's, and WT42BEUL20 for 20" TV's) also include our 8" Big Wheel Kit and our tip-resistant ballast system.
- ⇒ Shelves and legs are made from recyclable material.



Our versatile WT1642E includes 3 shelves (in one color) and the legs needed to make the four height options shown below!

Holds up to a 20" TV

WT42E
42"H

WT34E
34"H

WT26E
26"H

WT16E
16"H

MODEL	COLOR	SHELVES	HEIGHT	WEIGHT	UL LISTED
OPEN SHELF MODELS					
WT16E	CHOICE	2	16"	21 LBS.	-
WT26E	CHOICE	2	26"	22 LBS.	-
WT34E	CHOICE	3	34"	28 LBS.	-
WT42E	CHOICE	3	42"	29 LBS.	-
WT1642E	CHOICE	3	16-42"	30 LBS.	-
WT42BEUL13	CHOICE	3	42"	40 LBS.	Y
WT42BEUL20	CHOICE	3	42"	55 LBS.	Y

PLEASE SPECIFY COLOR CHOICE WHEN ORDERING